

ROOT VALVES FOR PRIMARY ISOLATION

This family of valves is designed for welding into a process line. Offered in many configurations with heavy duty needle valves or ball valves.

SINGLE BLOCK (BALL VALVE)

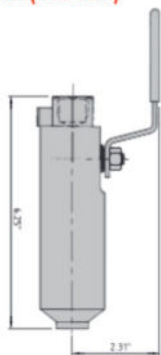

OTHER OPTIONS Heavy duty Needle valve as isolate.

BLOCK AND BLEED (BALL VALVE – ISOLATE) (NEEDLE VALVE – VENT)

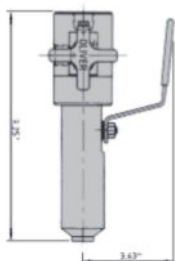

OTHER OPTIONS Ball valve as isolate and Ball valve as vent.



PRIMARY GAUGE OUTSIDE SCREW AND YOKE VALVE

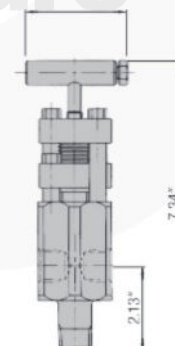

OTHER OPTIONS Available with handle locking.

DOUBLE BLOCK AND BLEED (ALL BALL VALVES)

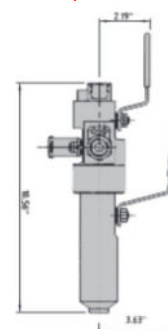

OTHER OPTIONS Two Ball valves as blocks and one Needle valve as vent. Three Needle valves as blocks and vent.

Major Weaknesses with Traditional Installation

- Cost of installation.
- Overall Size.
- Increased Gland Emission Risk.
- High bending moments hence need for gusset plates.
- Large number of potential leak points within assembly.
- Increased installation time due to complex arrangement.
- On-site welding due to gusset plates.
- Large number of items to stock and to purchase.

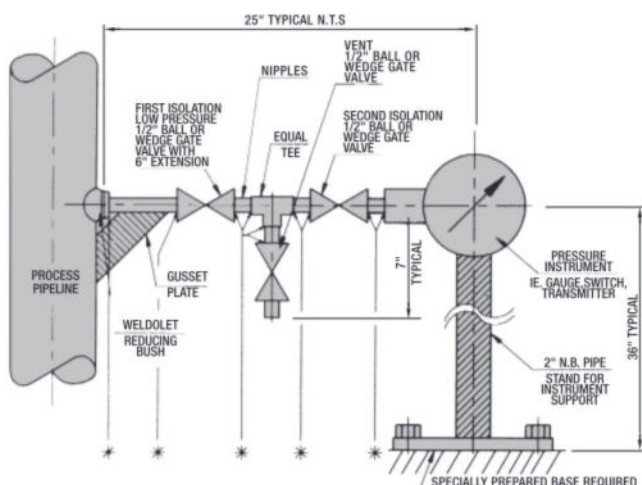

Major Advantages of Oliver Solution

- Safe Hook Up by Elimination of many potential leak points.
- Very cost competitive installation.
- Major space saving.
- Major weight saving.
- Compact/lightweight significantly reduces bending moments and pipework stresses.
- Firesafe to BS 6755 Pt 2, API 607 and API 6FA.
- Simplification of installation – direct labour time savings.
- Wide range of 6000 PSI, Ball, Needle and Check Valve styles.
- Wide range of materials and configurations (including NACE) on fast deliveries.
- One item only to stock.
- Greatly reduced maintenance.

