

UNIVERSAL MOUNTING BRACKET

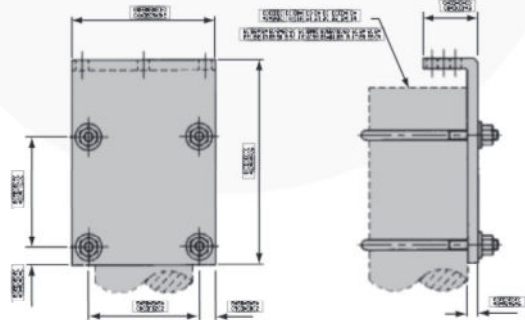

For mounting 2, 3 & 5 valve manifolds to a 2" NB pipestand. Mounting brackets supplied with "U" bolts, washers and nuts. Material of all components is zinc plated and passivated Carbon Steel. Special brackets can be supplied on request.

Y24/Y25

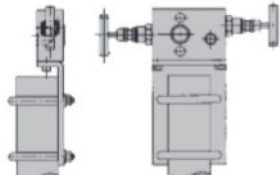

Y34/Y35

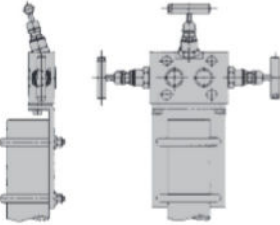

Y52/Y53

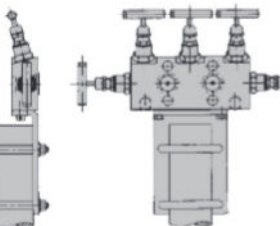

STEAM TRACE BLOCKS

The steam trace block is bolted to the manifold and because it is not an integral part of the manifold, stress levels (due to temperature cycling) are kept to a minimum. Steam trace blocks vary in size depending on manifold type.



MANIFOLD HEATING, ELECTRICAL

Specially designed 3/8" diameter cartridge manifold heater is available. The heater is inserted into the valve manifold and is protected by a brass cable gland and steel conduit designed for Zone 1 hazardous areas and approved to EExd and EExe IIc, BAS number: EX831220U. Output range either 25 or 50 watts, for 200/240 volts.

PP TYPE

1/4" & 1/2" pressure plugs.



CVP TYPE

Captive vent plugs 1/4" & 1/2" NPT size.

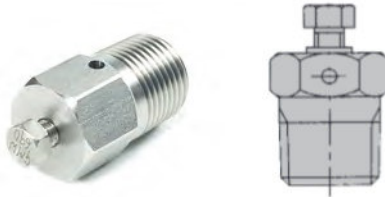

VP TYPE

Vent plugs 1/4" & 1/2" NPT sizes.



CVPT TYPE

Captive vent plug with T bar 1/2" NPT size.

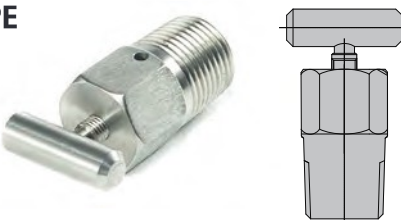

KIDNEY FLANGES



FLM50S TYPE

1/2" NPT Male threaded Kidney flange.

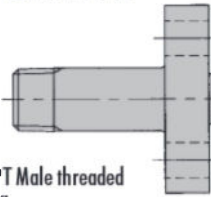

FLF50S TYPE

1/2" NPT Female threaded Kidney flange.

