



## 7C Series Ball Valves

Rated to 6000 psi

Multiple Connection Sizes

Low Operating Torque

SAFETY. INTEGRITY. RELIABILITY.



TABLE OF CONTENTS

7C Series Design Features & Typical Applications ..... 3

Female NPT Connections

Specifications & Dimensions..... 5

How to Order ..... 5

Materials of Construction ..... 6

Operating Specifications ..... 7

Optional Locking Plate..... 7

Integral / GYROLOK® Tube Connections

Specifications & Dimensions..... 9

How to Order..... 9

Materials of Construction ..... 10

Operating Specifications ..... 11

Optional Locking Plate..... 11

## HOKE® 7C Series Ball Valve

HOKE's 7C ball valve is designed for a range of media up to 6,000 psi. Its internally loaded blow-out proof stem and floating ball for positive shut-off along with its other features offer a robust, compact and easy to operate valve solution. The 7C is available in ¼" thru 1" NPT and integral / GYROLOK® tube connections. Please consult factory for additional material options.

### DESIGN FEATURES

- Female NPT connections
- Integral / GYROLOK® tube connections
- Sizes ¼", 3/8", 1/2", 3/4" and 1"
- Working pressures up to 6,000 psi
- Maximum operating temperature 150 C°
- Internally loaded blow-out proof stem
- Floating ball for positive shut-off
- Low operating torque
- Smooth 1/4 turn actuation
- 316 SS to NACE MR-01-75/ISO 15156
- Replaceable seats & seals
- Full material traceability
- Special High Tolerance NPT thread
- Locking Plate Optional (-LT Suffix)

### TYPICAL APPLICATIONS

- Controls & instrumentation isolation and venting
- Hydrocarbon Gas & Liquid service
- Hydraulic applications
- Wellhead Control Panels
- Chemical Injection Skids
- Utility services

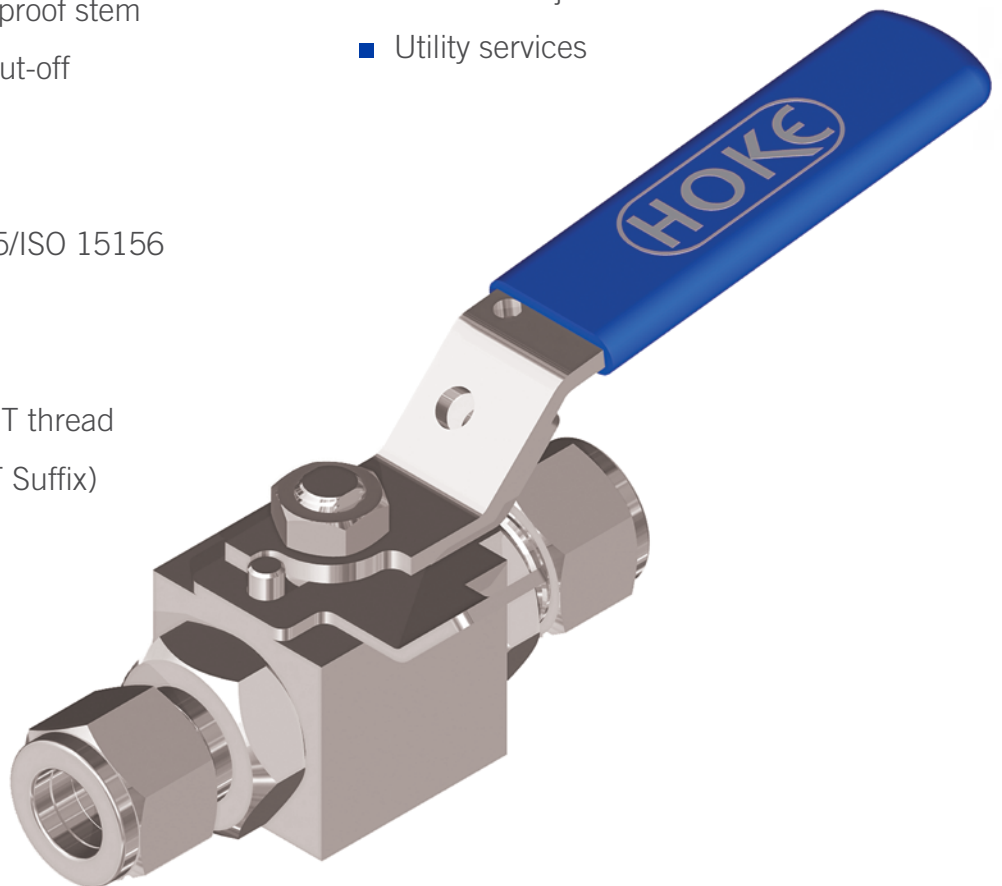

## 7C Series Ball Valve - Female NPT Connection



# 7C Series Ball Valve - Female NPT Connection

## Specifications & Dimensions

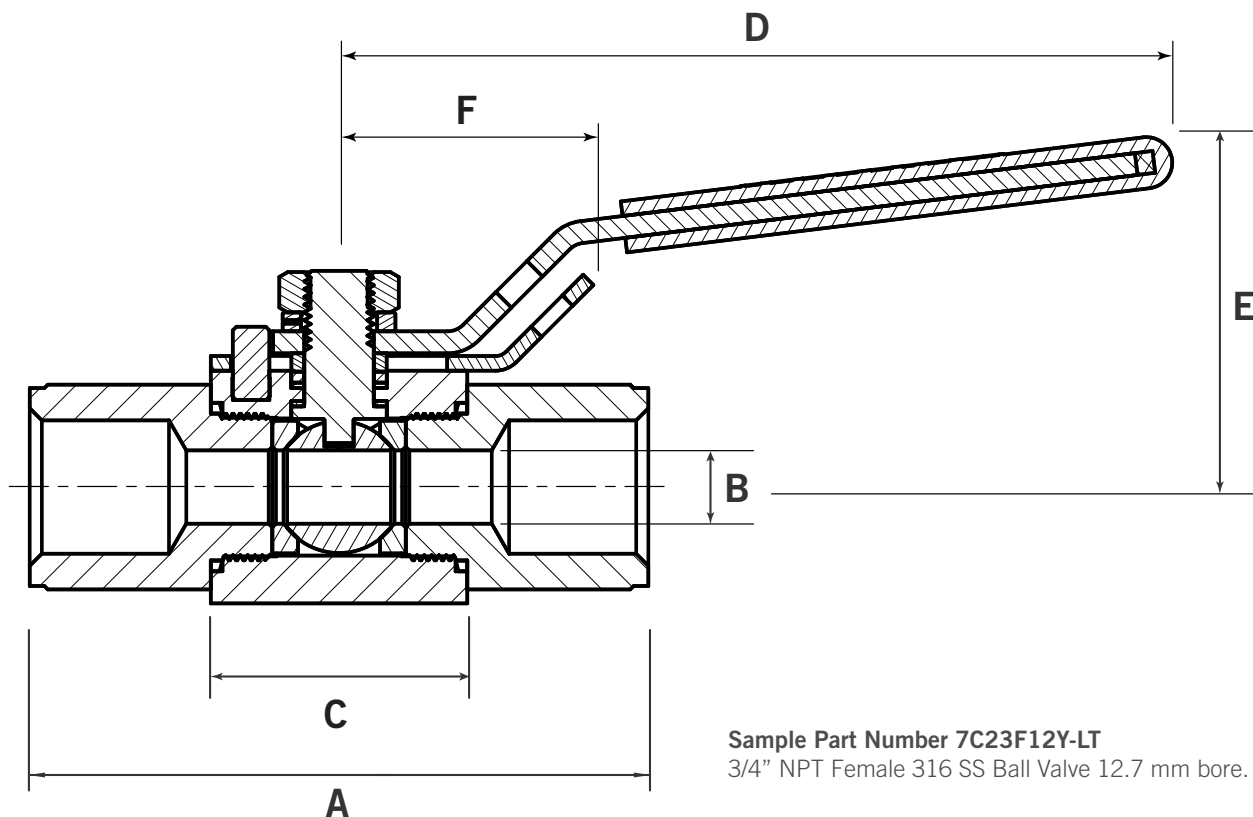

Sample Part Number 7C23F12Y-LT  
3/4" NPT Female 316 SS Ball Valve 12.7 mm bore.

**TO ORDER CHOOSE PART NUMBER WITH YOUR REQUIRED SPECIFICATIONS.**

### Specifications and dimensions in inches and (millimeters)

For reference only and subject to change

Part Number	Description	A	B	C	D	E	WT Kgs	CV <sub>US</sub>
7C23F4Y	1/4" F NPT	2.76 (70)	.39 (10)	1.26 (32)	4.52 (115)	1.85 (47)	0.457	7.5
7C23F6Y	3/8" F NPT	2.99 (76)	.39 (10)	1.26 (32)	4.52 (115)	1.81 (46)	0.463	7.5
7C23F8Y	1/2" F NPT	3.31 (84)	.39 (10)	1.25 (31.8)	4.48 (114)	1.81 (46)	0.501	7.5
7C23F12Y	3/4" F NPT	3.50 (89)	.50 (12.7)	1.25 (31.8)	4.48 (114)	1.93 (49)	0.755	12.0
7C23F16Y	1" F NPT	4.37 (111)	.75 (19.05)	2.0 (50.8)	7.72 (196)	2.72 (69)	1.669	32.0

To order locking plate option, add -LT to valve part number.

### Custom Options

Please consult factory for other materials, bore sizes, handle options and connection options.

The actual pressure ratings for any alternative option will vary from those stated – please consult with factory for your specific requirements.

The specification of any alternative material, connection or tubing is critical to the overall performance of the system.

Caution should be exercised by the user to ensure proper selection in accordance with actual operating or design conditions.

# 7C Series Ball Valve - Female NPT Connection

Materials of Construction Shown with Optional Locking Plate

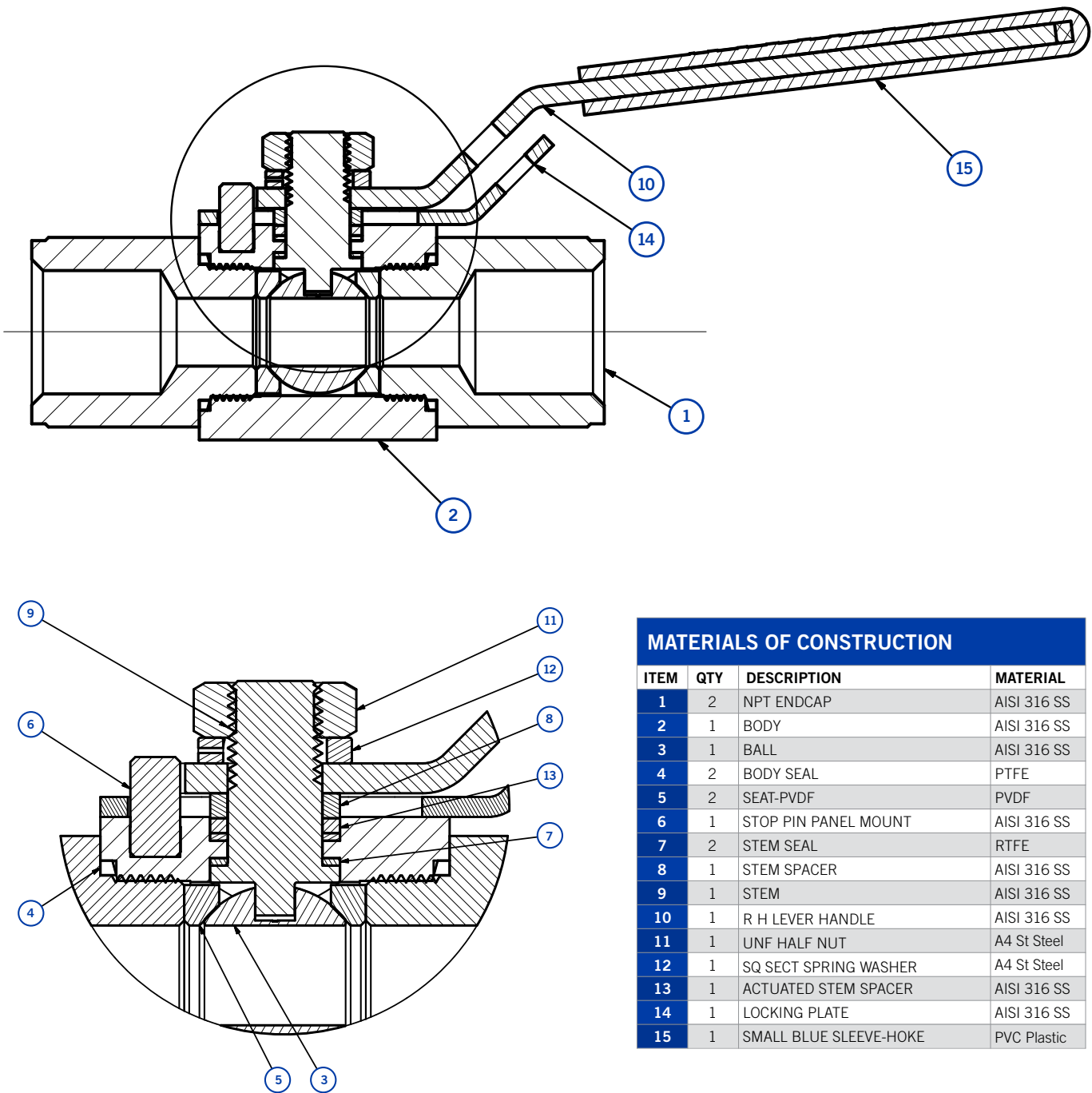

Sample Part Number 7C23F8Y-LT  
1/2" NPT Female 316 SS Ball Valve 10 mm bore.

# 7C Series Ball Valve- Female NPT Connection

## Operating Specifications

### 7C Series Pressure / Temperature Graph

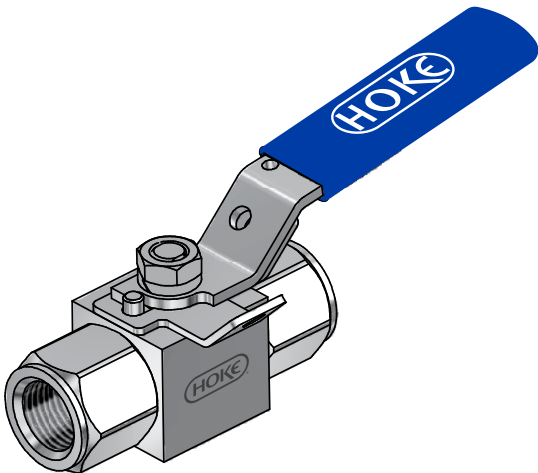
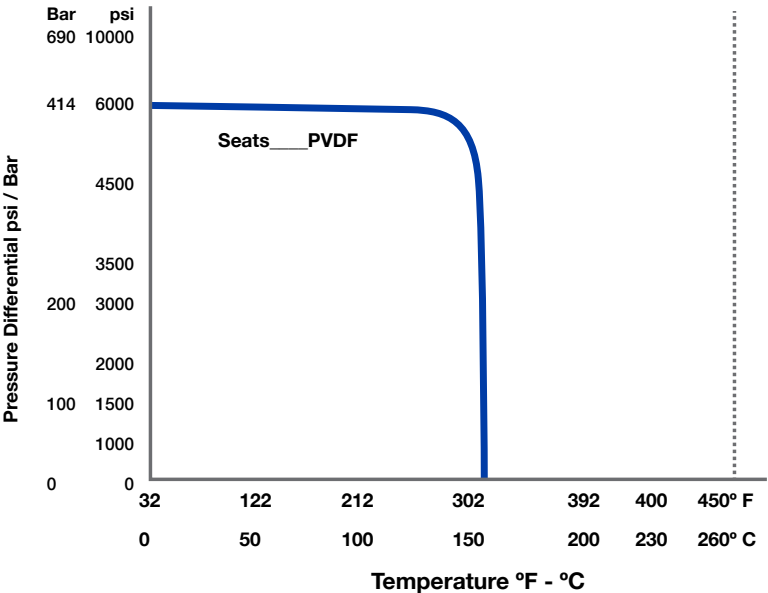

TECHNICAL DATA		
MAX. OPERATING PRESSURE	6000 PSI	414 BAR
MAX OPERATING TEMPERATURE	302 °F	150 °C
MIN OPERATING TEMPERATURE	-22 °F	-30 °C
BASIC MATERIAL	316 STAINLESS STEEL	

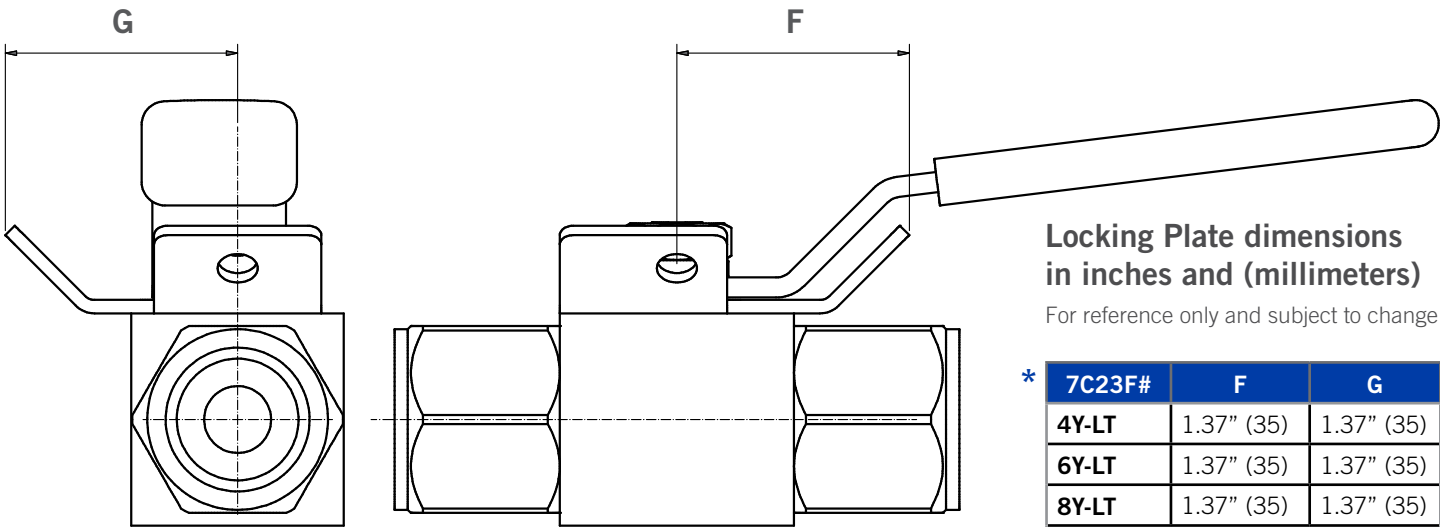

### Locking Plate dimensions in inches and (millimeters)

For reference only and subject to change

* 7C23F#	F	G
4Y-LT	1.37" (35)	1.37" (35)
6Y-LT	1.37" (35)	1.37" (35)
8Y-LT	1.37" (35)	1.37" (35)
12Y-LT	1.37" (35)	1.37" (35)
16Y-LT	1.89" (48)	1.89" (48)

\*To order locking plate option, add -LT to valve part number as shown

## 7C Series Ball Valve - Integral / GYROLOK® Tube Connections

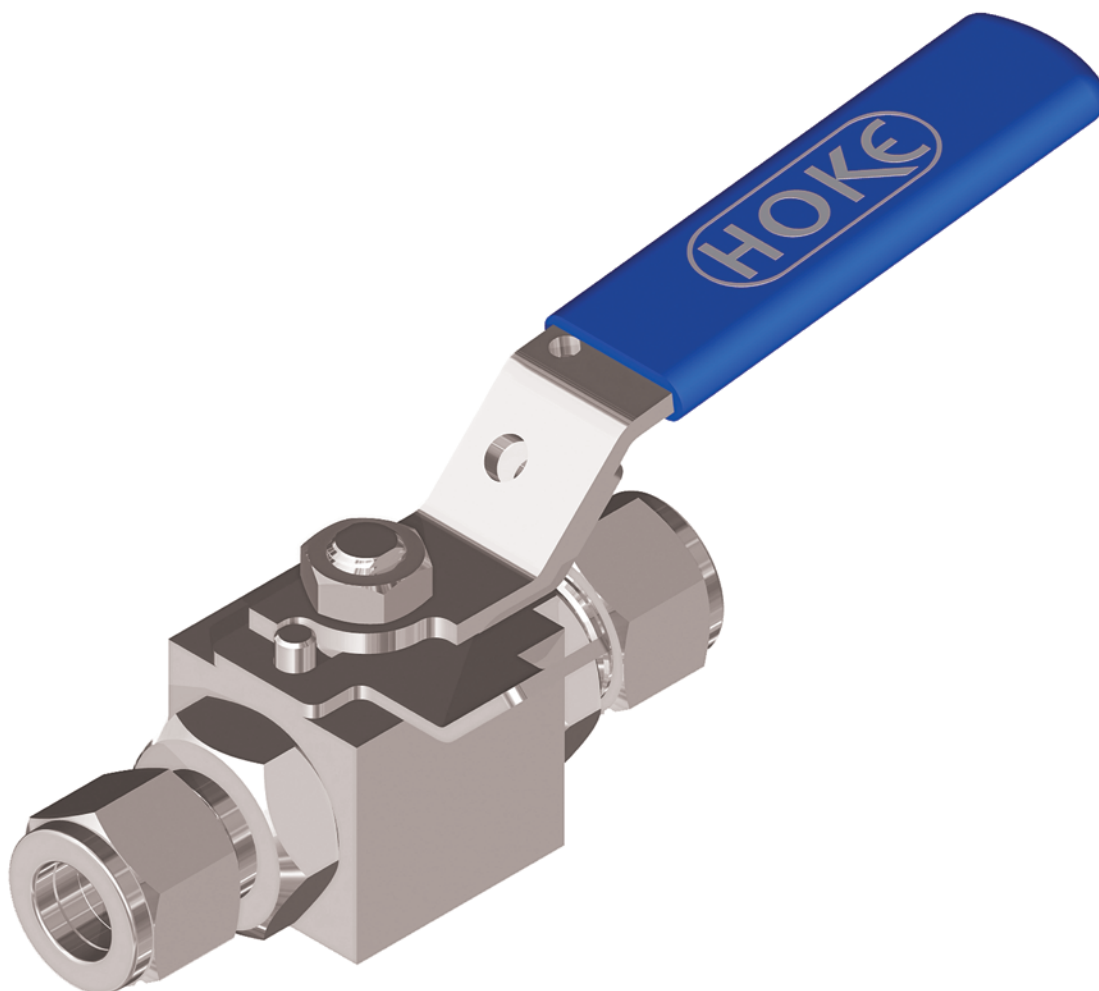



# 7C Series Ball Valve - Integral / GYROLOK® Tube Connections

## Specifications & Dimensions

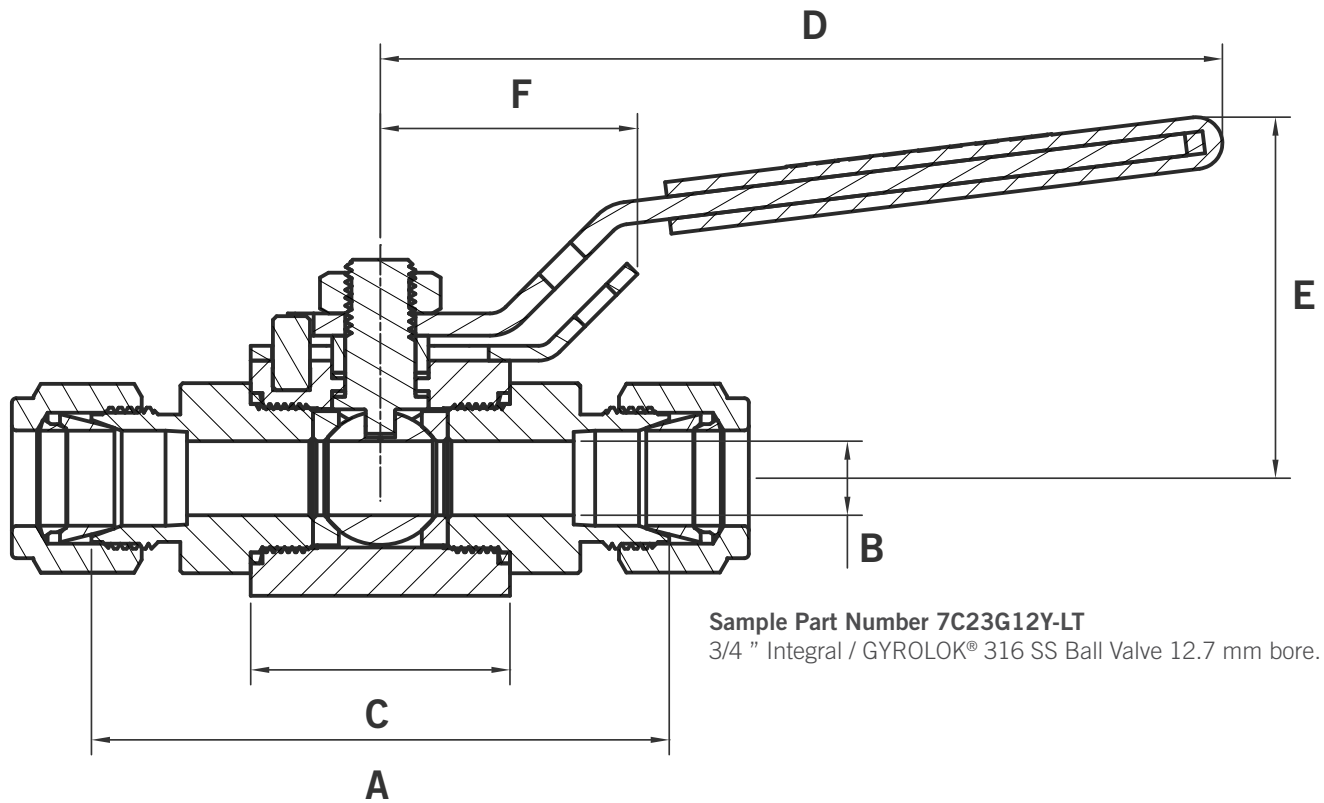

**TO ORDER CHOOSE PART NUMBER WITH YOUR REQUIRED SPECIFICATIONS.**

### Specifications and dimensions in inches and (millimeters)

For reference only and subject to change

Part Number	Description	A	B	C	D	E	F	WT Kgs	CV <sub>US</sub>
7C23G4Y	1/4"	2.83" (72)	0.39" (10)	1.37" (35)	4.52" (115)	2.16" (55)	1.37" (35)	0.45	7.5
7C23G6Y	3/8"	2.95" (75)	0.39" (10)	1.37" (35)	4.52" (115)	2.16" (55)	1.37" (35)	0.46	7.5
7C23G8Y	1/2"	2.95" (75)	0.39" (10)	1.37" (5)	4.52" (115)	2.16" (55)	1.37" (35)	0.50	7.5
7C23G12Y	3/4"	2.99" (76)	0.50" (12.7)	1.37" (35)	4.52" (115)	2.40" (61)	1.37" (35)	0.75	12.0
7C23G16Y	1"	4.13 " (105)	0.75" (19.05)	2.04" (38)	7.72" (196)	2.63" (67)	1.89" (48)	1.6	32.0

For locking handle option, add -LT to valve part number.

### Custom Options

Please consult factory for other materials, bore sizes, handle options and connection options.

The actual pressure ratings for any alternative option will vary from those stated – please consult with factory for your specific requirements.

The specification of any alternative material, connection or tubing is critical to the overall performance of the system.

Caution should be exercised by the user to ensure proper selection in accordance with actual operating or design conditions.

# 7C Series Ball Valve - Integral / GYROLOK® Tube Connections

## Materials of Construction

Shown with Optional Locking Plate

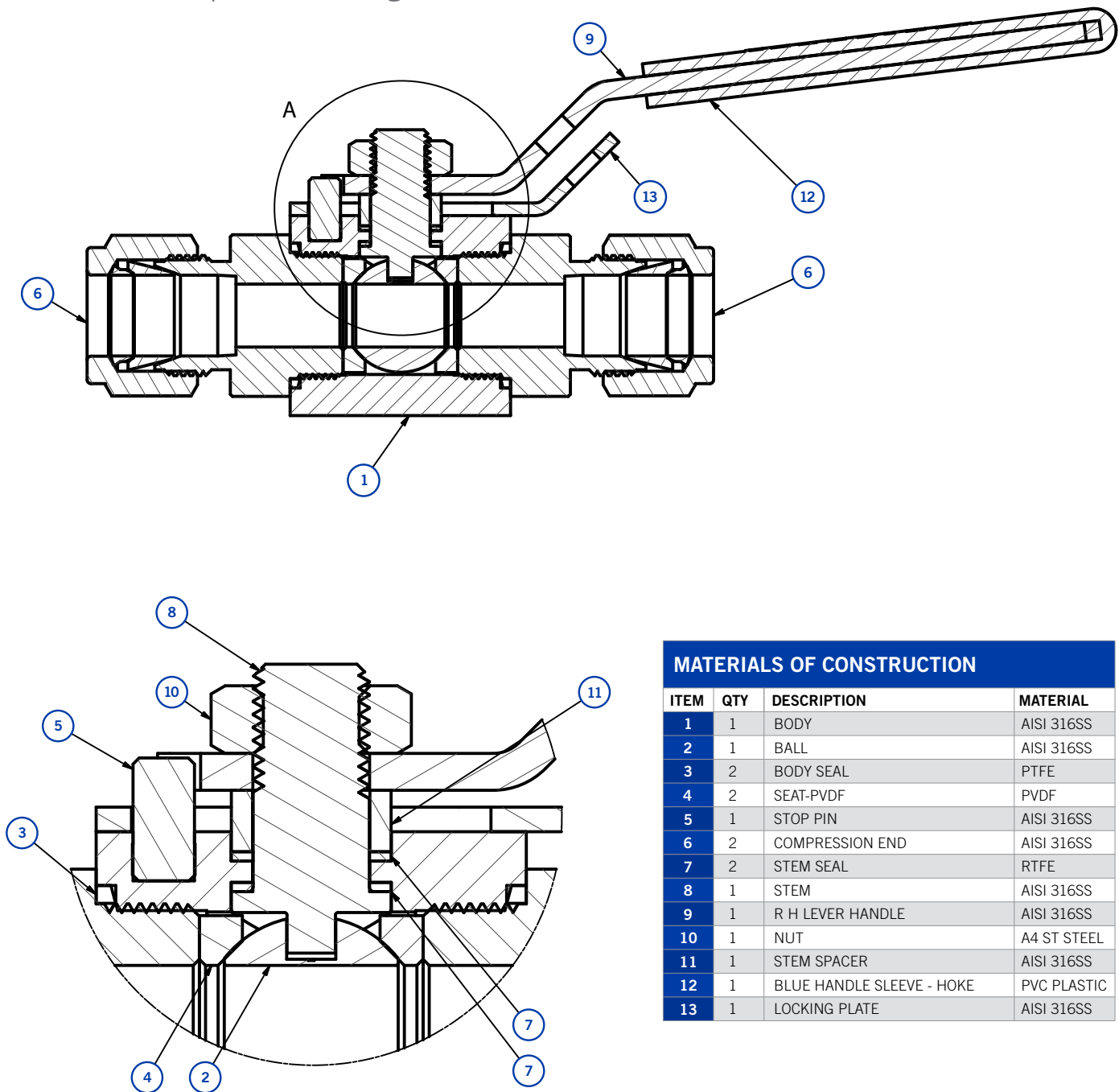

MATERIALS OF CONSTRUCTION			
ITEM	QTY	DESCRIPTION	MATERIAL
1	1	BODY	AISI 316SS
2	1	BALL	AISI 316SS
3	2	BODY SEAL	PTFE
4	2	SEAT-PVDF	PVDF
5	1	STOP PIN	AISI 316SS
6	2	COMPRESSION END	AISI 316SS
7	2	STEM SEAL	RTFE
8	1	STEM	AISI 316SS
9	1	R H LEVER HANDLE	AISI 316SS
10	1	NUT	A4 ST STEEL
11	1	STEM SPACER	AISI 316SS
12	1	BLUE HANDLE SLEEVE - HOKE	PVC PLASTIC
13	1	LOCKING PLATE	AISI 316SS

Sample Part Number 7C23G8Y-LT  
1/2" Integral / GYROLOK® 316 SS Ball Valve 10mm bore.

# 7C Series Ball Valve - Integral / GYROLOK® Tube Connections

## Operating Specifications

### 7C Series Pressure / Temperature Graph

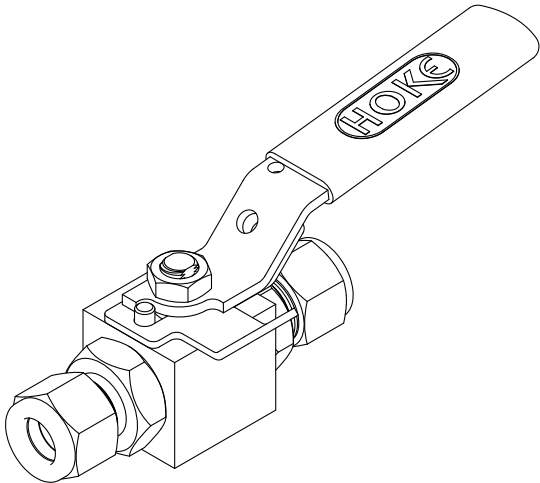
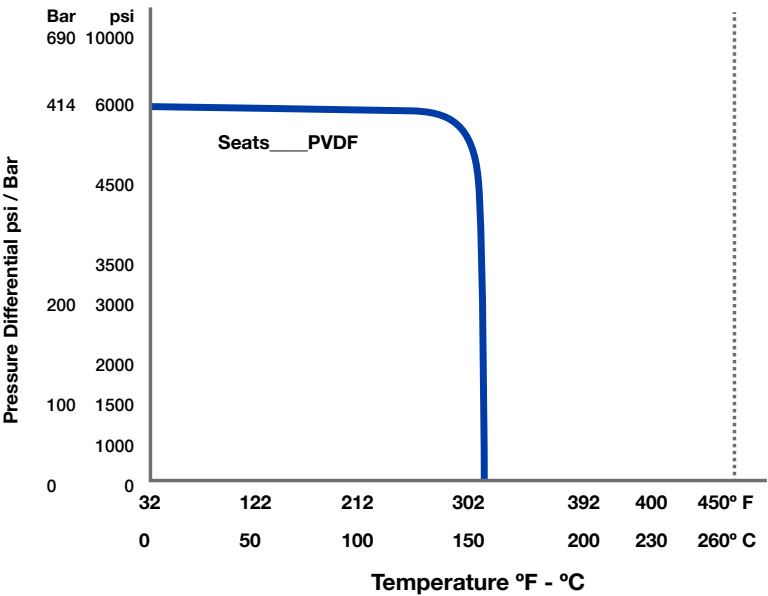

TECHNICAL DATA		
MAX. OPERATING PRESSURE	6000 PSI	414 BAR
MAX OPERATING TEMPERATURE	302 °F	150 °C
MIN OPERATING TEMPERATURE	-22 °F	-30 °C
BASIC MATERIAL	316 STAINLESS STEEL	

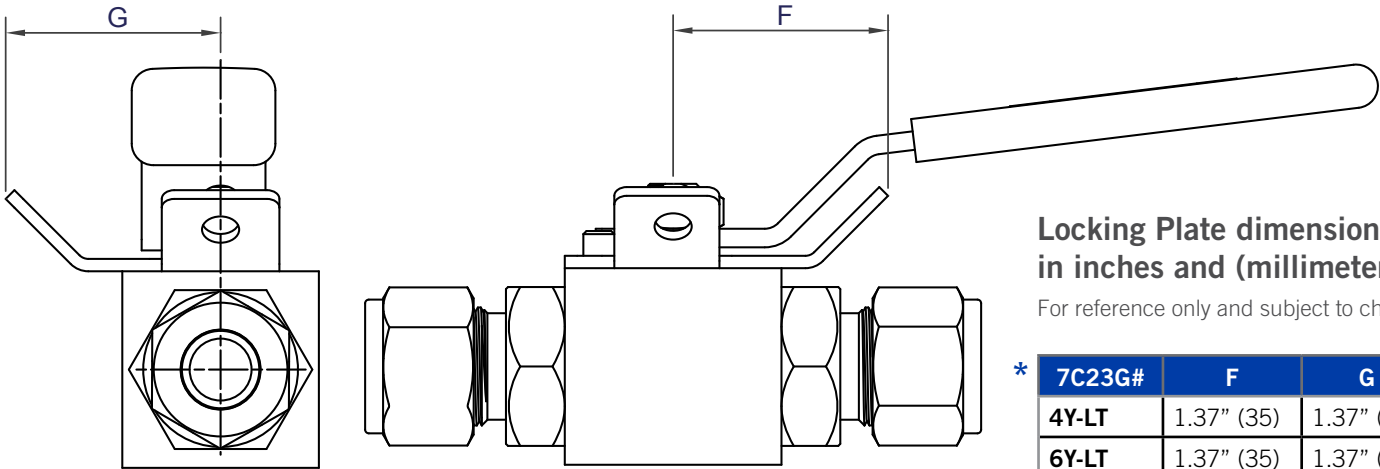

### Locking Plate dimensions in inches and (millimeters)

For reference only and subject to change

* 7C23G#	F	G
4Y-LT	1.37" (35)	1.37" (35)
6Y-LT	1.37" (35)	1.37" (35)
8Y-LT	1.37" (35)	1.37" (35)
12Y-LT	1.37" (35)	1.37" (35)
16Y-LT	1.89" (48)	1.89" (48)

\*To order locking plate option, add -LT to valve part number as shown

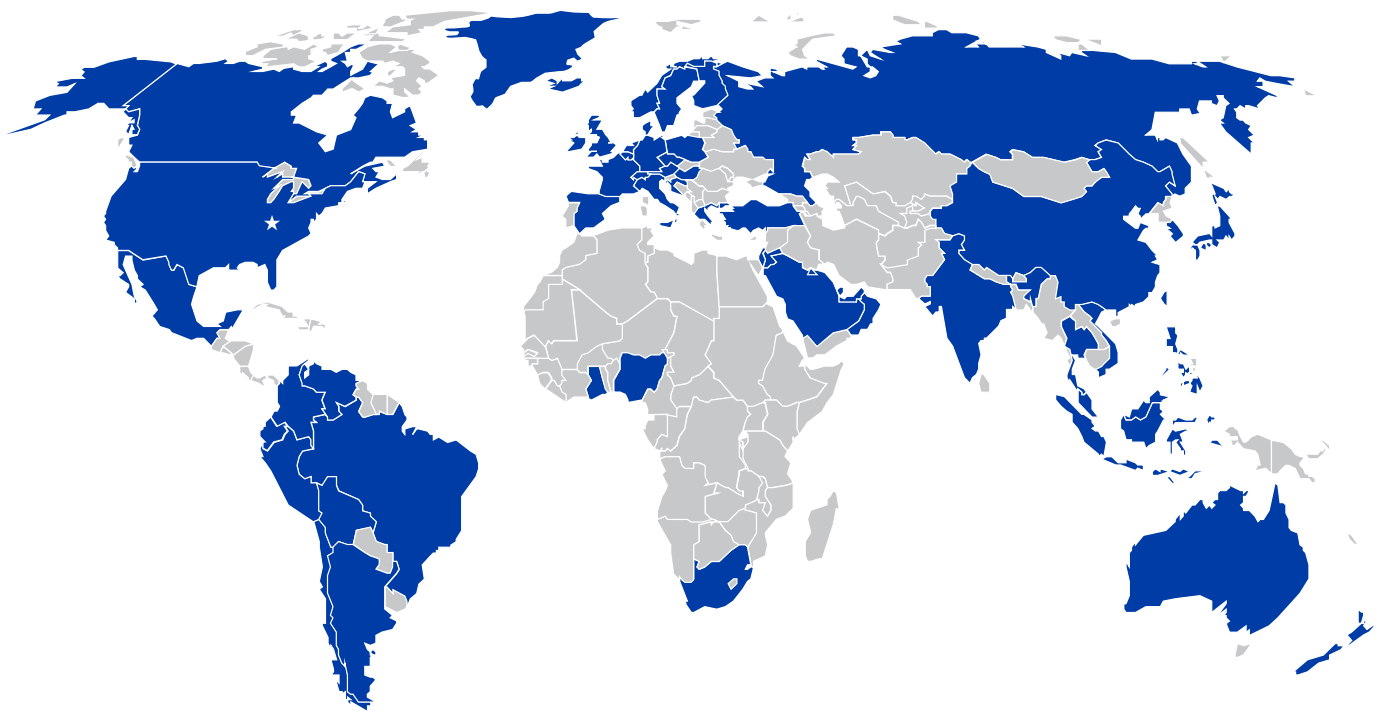

The HOKE® Brand is just one product offering manufactured and supplied by CIRCOR Instrumentation, an ISO 9001:2008 registered facility headquartered in Spartanburg, SC, USA, a division of CIRCOR International (NYSE:CIR).

**HOKE distributors are worldwide.**

Contact us or visit our website to locate the nearest distributor to assure your projects are consistently implemented across the globe with the greatest Safety, Integrity and Reliability.



PO Box 4866  
Spartanburg, SC 29305-4866  
Tel +1-864-574-7966  
Fax +1-864-587-5608  
[www.hoke.com](http://www.hoke.com)  
[sales-hoke@circor.com](mailto:sales-hoke@circor.com)

Our headquarters and manufacturing facilities are located at:  
405 Centura Ct.  
Spartanburg, SC, USA,  
29303-6603