



6800 Series

Gauge Valves



Features

- Corrosion-resistant bar stock 316 stainless steel bodies
- Packing below stem threads prevents contamination and wash away of thread lubricants to assure long valve life
- Hardened 17-4 PH 2-piece, non-rotating stem point minimizes seat galling and provides an excellent metal-to-metal seat for positive shutoff
- Low profile bonnet assembly and large diameter stem reduces damage to bonnet and stem assembly
- Roll pin locks bonnet in the valve body to prevent accidental removal
- Choice of 5 $\frac{3}{8}$ " long body for standard process use or 7 $\frac{3}{8}$ " body for insulated piping applications
- Three outlets meet individual gauge requirements
- Polyethylene cap protects stem and bonnet from external damage
- Rugged large handle provides easy grip and control
- All models are stamped with maximum operating pressures on valve body
- High temperature packing is available on special order
- Special High Tolerance NPT Thread

Technical Data

Body Material	316 stainless steel
Maximum Operating Pressure	<ul style="list-style-type: none">• 6000 psig @ -65° to +200° F (414 bar @ -54° C to +93° C)• 3000 psig @ +450° F (207 bar @ +232° C)
Operating Temperature Range	-65° F to +450° F (-54° C to +232° C)
Orifice Sizes	6801L8Y: 0.156" (3.96mm) All others: 0.187" (4.75mm)

HOKE Inc.

PO Box 4866 • Spartanburg, SC 29305-4866
Phone (864) 574-7966 Fax (864) 587-5608
www.hoke.com • Sales-hoke@circor.com

gauge valves

6800 Series

Materials of Construction

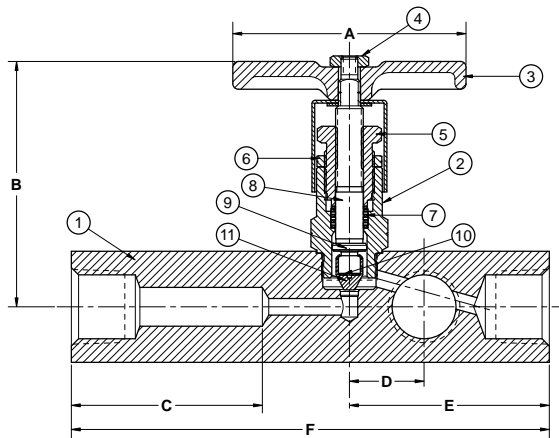

Part	316 Stainless Steel Models
1	Body
2	Housing
3	Handle
4	Hex nut
5	Packing nut
6	Lock nut
7	Packing*
8	Stem
9	Washer
10	Disc
11	Stem point

* Model 6801L8Y uses a single-piece molded PTFE packing system.

Pressure vs. Temperature

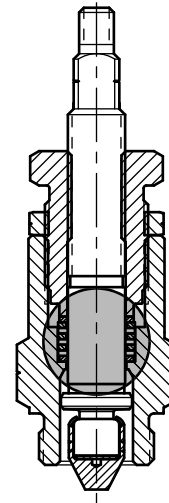
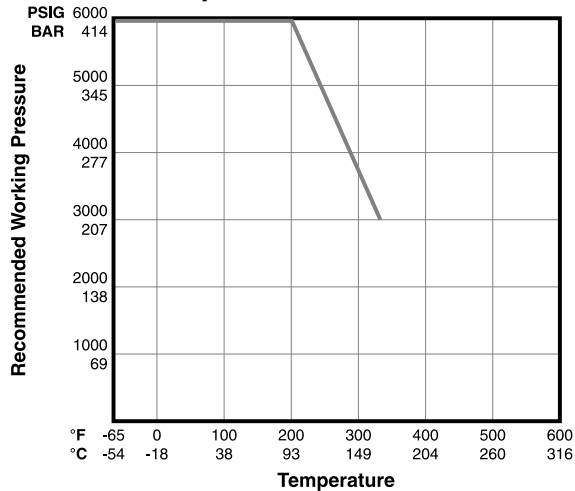

Dyna-Pak® Packing

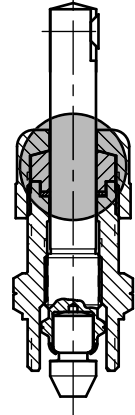

TFE Packing
(6801L8Y only)

Dimensions

Model Number		A	B	C	D	E	F
6801L8Y	inch	1¼	2½	1	¾	1¾	3¼
	mm	32	64	25	14	44	83
6802L8Y	inch	2½	3	2½	2½	2¼	5¾
	mm	67	75	55	21	57	136
6803L128Y	inch	2½	3	2½	2½	2¼	5¾
	mm	67	75	55	21	57	136
6805L128Y	inch	2½	3	4½	2½	2¼	7¾
	mm	67	75	106	21	57	188

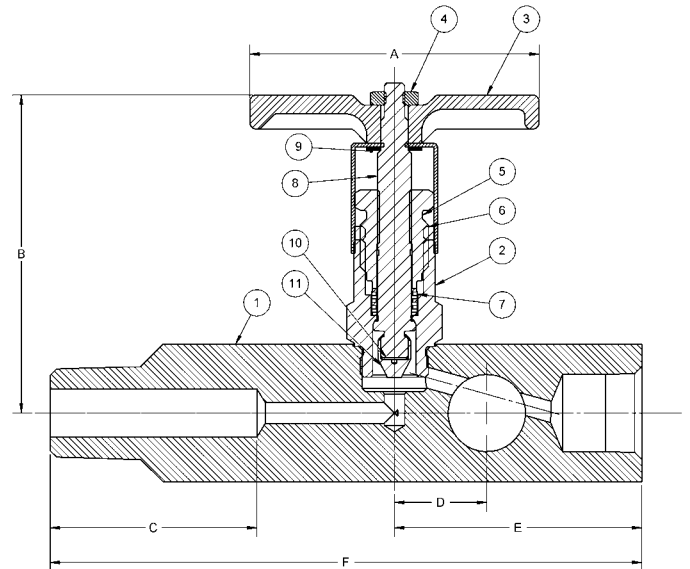

How to Order: Standard Valves

Connections		Order by Part Number 316 Stainless Steel	Body Length	
Inlet	Outlet		Inch	mm
½" NPT male	½" NPT female	6801L8Y*	3¼	83
½" NPT male	½" NPT female (3x)	6802L8Y	5¾	136
½" NPT female	½" NPT female (3x)	6802F8Y	5¾	136
¾" NPT male	½" NPT female (3x)	6803L128Y	5¾	136
¾" NPT male	½" NPT female (3x)	6805L128Y	7¾	188

* Furnished with bleed plug drilled in body

Model 6801L8Y uses a single-piece molded PTFE packing system

Dyna-Pak® is a registered trademark of HOKE Incorporated.